

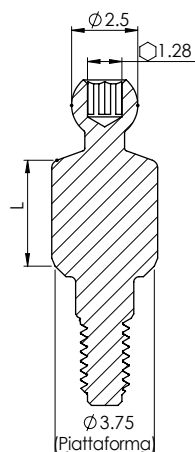







RIABILITAZIONI OVERDENTURE | ATTACCHI A SFERA



CARATTERISTICHE	<ul style="list-style-type: none"> • Attacco a sfera • Varie altezze del tragitto transmucoso • Componenti - cappetta metallica e varie cappette in nylon
VANTAGGI	<ul style="list-style-type: none"> • Attacchi per riabilitazioni overdenture • Varie altezze gengivali • Varie tipologie ritentive
MATERIALE	Lega di titanio (Ti-6Al-4V ELI)

SPECIFICHE TECNICHE



Attacchi a sfera	L (mm)	Attacchi a sfera	L (mm)
	0.5		4
NM-T1200		NM-T1204	
	1		5
NM-T1201		NM-T1205	
	2		6
NM-T1202		NM-T1206	
	3		
NM-T1203			

Cappette da 2,5 mm per attacchi a sfera

Metallo	Extra morbida in nylon	Morbida in nylon	Standard in nylon
			
NM-T3001	NM-T3002	NM-T3003	NM-T3004