

SCREW RETAINED RESTORATIONS | MULTI-UNIT PROTOCOL

ASSEMBLY OF A STRAIGHT MULTI-UNIT BASE

1
Attach the straight Multi-Unit base to the implant by using the plastic handle.



2
Remove the handle.



3
Tighten the base to 30Ncm with the Multi-Unit driver.



ASSEMBLY OF ANGLED MULTI-UNIT BASE

1
Use the Angled Guide Pin to choose the correction angle.



2
Attach the Multi-Unit base to the appropriate angle.

Use the handle as an indicator for the final screw emergence.

3
Tighten the base to 30Ncm with the 1.25mm Hex driver or a Star driver.

4
Remove the handle by unscrewing it out.

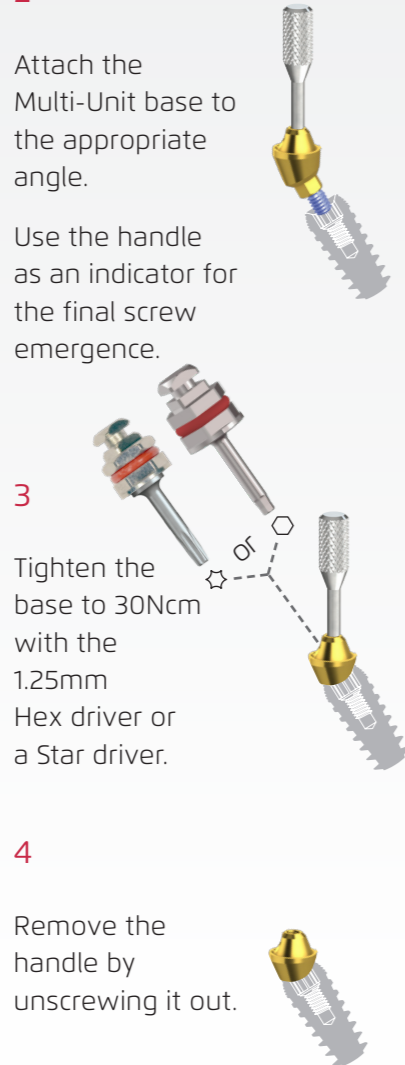

HEALING CAPS ASSEMBLY

IMPRESSION

Choose the desired impression technique:

For closed tray choose Snap-On-transfer.

For open tray technique choose conventional transfer.



SCREW RETAINED RESTORATIONS | MULTI-UNIT PROTOCOL

IMMEDIATE LOADING (FABRICATION OF THE TEMPORARY BRIDGE)

1
Assemble the Titanium Sleeve on the Multi-Unit base and tighten the screw to 25Ncm.



2
Attach the pre-prepared provisional acrylic prosthesis



LABORATORY PHASE

1
Mount the Plastic Sleeve on the Multi-Unit analog and tighten with the screw.

2
Splint the sleeves.

3
Carve the Sleeves to the desired shape.

4
Invest and cast the metal frame of the prosthesis.

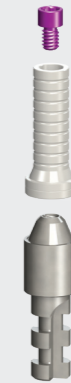

PASSIVE FIT CASTABLE ABUTMENT SET

The Passive Fit Castable Abutment Set consists of three parts aimed for the fabrication of accurate metal reinforced prostheses. The uniquely designed Castable Sleeve Positioner is used for aligning the Castable Sleeve on the plaster model, ensuring passive fit of the fabricated metal cast when cemented to the Titanium Abutments.

Tighten final prosthetic crown/bridge screw to the MULTI-UNIT at 25Ncm.

