

CAD/CAM COMPONENTS | TI-BASES FOR INTERNAL HEX IMPLANTS

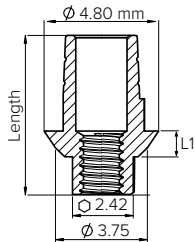

DESIGN FEATURES	<ul style="list-style-type: none"> • Anti-rotational and non-engaging design • Range of Gingival heights
CLINICAL BENEFITS	<ul style="list-style-type: none"> • Cement retained abutments • Gingival Collar height selection • Range of emergence profiles abutment options
MATERIAL	<ul style="list-style-type: none"> • Titanium Alloy (Ti-6Al-4V ELI)

ORDERING INFORMATION



(* IN SIRONA CEREC SYSTEM
CHOOSE ZIMMER TAPRED SCREW
VENT 3.5mm PLATFORM

Single Unit Titanium Base for Crown	Ø D (mm)	L (mm)	L1 (mm)	Ref. No
	4.8	4.5	0.7	NM-C2201
	4.8	6.0	2	NM-C2212
	4.8	7.0	3	NM-C2213
(*)	4.2	6.8	0.3	NM-C2230

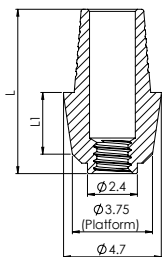

Non-Hexed Titanium Base for Bridge	Ø D (mm)	L (mm)	L1 (mm)	Ref. No
	4.8	5.5	0.6	NM-C2202
	4.8	6.9	2	NM-C2222
	4.8	7.9	3	NM-C2223

	Included with all abutments & available separately	Ref. No NM-S8324
--	--	------------------



Noris Medical's CAD/CAM libraries are available for the following software: Exocad, 3Shape and Dental Wings. The most current libraries can be found in Noris Medical's website.

